

# W8LMD

Three-way mini, vertically arrayable enclosure

## features

- ▶ Stand alone vertically arrayable enclosure
- ▶ Line array downfill element
- ▶ Consistent 120° (-6dB) horizontal mid and HF pattern control
- ▶ 20° (-6dB) vertical dispersion
- ▶ Tripod mountable singularly or in pairs
- ▶ Amplitude shading switch
- ▶ Passive or Bi-Amp format
- ▶ Compatible with WMX, WLX, WSXa, WS2A & WS218X sub-basses

## applications

- ▶ Short to medium throw arrays of 1 to 4 cabinets
- ▶ Vertically arrayed downfill for W8LM systems
- ▶ Theatre sound reinforcement
- ▶ Corporate events
- ▶ Fixed installations

The Martin Audio W8LMD is a mini, wide-dispersion vertically arrayable enclosure. It can be used individually and in small quantities for short to medium throw applications (up to 30 metres) as well as a downfill element for the W8LM. Its 20° vertical dispersion requires fewer cabinets to cover the same area as a conventional line array element, yet it still benefits from the smooth, predictable coverage of a vertically coupled system.

## overall dimensions

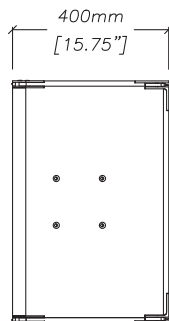
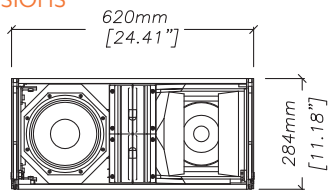

W8LMD



## technical specifications

TYPE	Three-way, active/passive, mini downfill line array element
FREQUENCY RESPONSE (5)	60Hz-18kHz $\pm$ 3dB
DRIVERS: LF + MF Section	8" (200mm)/2" (50mm) voice coil, reflex-loaded direct radiator
HF Section	8" (200mm)/2" (50mm) voice coil, neodymium driver, front horn loaded, rear reflex loaded 2 x 1" (25mm) exit HF compression drivers, horn loaded
RATED POWER (2)	LF + MF: 400W AES, 1600W peak HF: 75W AES, 300W peak FR: 400W AES, 1600W peak
RECOMMENDED AMPLIFIER	MA5.2K
SENSITIVITY (6)	LF + MF: 99dB HF: 104dB FR: 98dB rising to 103dB at HF
MAXIMUM SPL (calculated @ 1m)	LF + MF: 125dB continuous, 131dB peak HF: 123dB continuous, 129dB peak FR: 124dB continuous, 130dB peak
NOMINAL IMPEDANCE	LF + MF: 12 ohms HF: 12 ohms FR: 12 ohms
DISPERSION (-6dB)	120° horizontal (down to 750Hz), 20° vertical 140° horizontal (down to 650Hz) @ -10dB
CROSSOVER	300Hz passive, 2.2kHz active or passive Shading control switch – rear mounted
ENCLOSURE	Vertical trapezoid with 10° wall angle, multi-laminate birch ply construction
FINISH	Textured black paint
PROTECTIVE GRILLE	Black perforated steel
CONNECTORS	2 x Neutrik NL4
FITTINGS	Proprietary rigging system 2 x pocket handles each side 4 x M8 inserts for externally mounted top hat fitting
DIMENSIONS	(W) 620mm x (H) 284mm x (D) 400mm (W) 24.4ins x (H) 11.2ins x (D) 15.8ins
WEIGHT (inc. rigging hardware)	30kg (66lbs)

Century Point, Halifax Road, Cressex Business Park,  
High Wycombe, Buckinghamshire HP12 3SL, England.  
Telephone: +44 (0)1494 535312 Facsimile: +44 (0)1494 438669  
E-mail: info@martin-audio.com  
All information is Copyright © 2011 Martin Audio Ltd.



[www.martin-audio.com](http://www.martin-audio.com)

touring and theatre