



AcousticPerformance™ Series

AP-5102

High power, installation
loudspeaker

Features

- DMT™ (Directivity Matched Transition) ensures smooth, coherent power response across the listening plane
- 105 degree coverage of the axisymmetric waveguide matches natural coverage of the 10-inch woofer at the crossover point for consistent power response
- 3-inch voice coil compression driver for outstanding high-frequency performance
- M10 fittings and yoke mount fittings offer flexible deployment options for a variety of applications
- Clean industrial design with unadorned grilles compliment most decors and settings
- NL4 Speakon™ connector and covered barrier strip terminals
- Bi-Amp / Passive switchable
- 15-ply Baltic birch plywood construction
- 16-Gauge powder coated steel grilles
- Conforms to tests outlined in ANSI/ EIA-636: Recommended Loudspeaker Safety Practices
- Available in black (RAL 9011) and white (RAL 9010)
- Complete EASE, CAD & BIM information available at qsc.com



Performance Spaces · Worship Facilities · Dance/Night Clubs · Sports Facilities · Themed Entertainment

The QSC AcousticPerformance™ AP-5102 is a professional, two-way, fullrange loudspeaker ideal for a variety of installed sound reinforcement applications requiring high power, wide coverage and compact size. The AP-5102 uses a high power-capacity, 76mm (3-inch) diaphragm compression driver and combines it with a 254mm (10-inch) woofer to deliver exceptional full bandwidth reproduction.

The uniform power-response of the AP-5102 loudspeaker is a result of DMT™ (Directivity Matched Transition), a design approach that matches LF and HF coverage in the cross-over region. Another key to the extraordinary accuracy and flat power response of the AP-5102 is the axisymmetric waveguide with uncompromised performance in both the vertical and horizontal axes. The result is remarkably consistent coverage and smooth, accurate reproduction on and off-axis.

The AP-5102 may be used as a passive (full-range) loudspeaker to minimize amplifier channel count or it may be bi-amplified for greater control and performance. To further enhance performance, full-range and bi-amp tunings using QSC Intrinsic Correction™ techniques are available for the Q-Sys™ networked audio processing platform as well as CXD and PLD amplifiers.

The AP-5102 enclosure features M10 mounting points for suspension via eye-bolts as well as mount points for an optional yoke bracket.

Presenting a clean, unobtrusive look, AcousticPerformance grilles are unadorned eliminating the need to cover-up logo treatments which can be difficult to hide or remove. The grille is also lined with acoustically transparent backing adding to the enclosure's professional appearance. The AP-5102 is available in black (RAL 9011), and white (RAL 9010) finishes.

To minimize impact and disposal fees at the job site, all AcousticPerformance loudspeakers are packaged in environmentally friendly, recyclable cartons.

AP-5102 Details

Beamwidth:

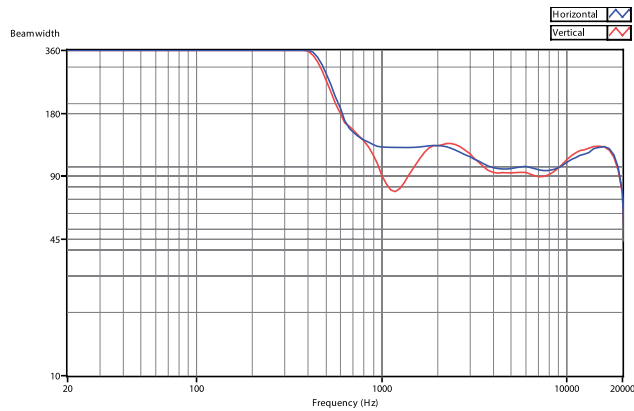

Impedance / Frequency Response:

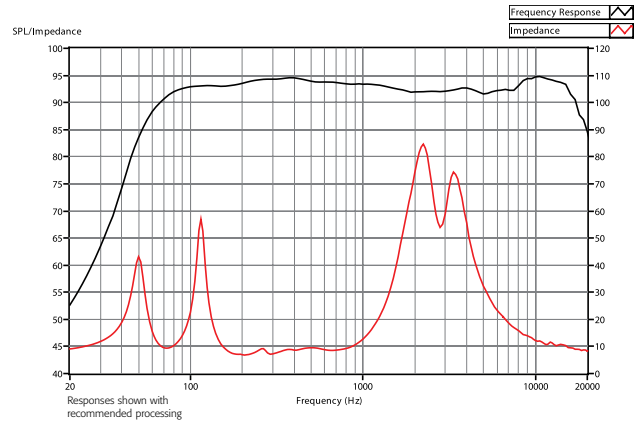

Signal Flow:

Input Cup:

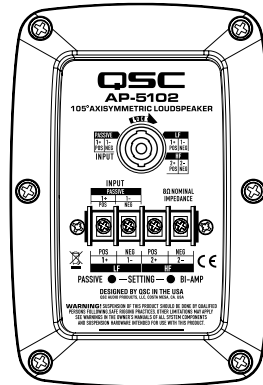

Specifications:

System Details	AP-5102
Frequency Response (-10dB)	60Hz – 18kHz
Power Capacity ¹	450W / 54V continuous
System Sensitivity ²	94dB, 1W@1m
Coverage Angle	105° Axisymmetric
Directivity Factor (Q)	4.6
Directivity Index (DI)	6.6
Recommended Crossover	950 Hz, 48dB/octave
Maximum Rated SPL	Passive: 121dB @1m, continuous ³ 127dB @1m, peak ⁴
Rated Impedance	8Ω
HF Transducer	76mm (3-inch) voice coil, compression driver; 72W / 24V (2 Hrs)
LF Transducer	254mm (10-inch) driver with 76mm (3-inch) VC; 450W / 54V (2 Hrs)
Optional Accessories	AP-YM10 Yoke mount M10 Kit-W
Enclosure Details	
Input Connector	Covered Barrier Strip, NL4 connector
Enclosure Material	15-ply Baltic birch plywood
Attachment Points	15x M10 threaded inserts
Color	Black (RAL 9011), White (RAL 9010)
Grille	16 Gauge powder coated steel
Dimensions (HxWxD)	559mm x 305mm x 267mm (22x12x10.5-inches)
Net Weight	21.7 kg (48 lb)
Shipping Carton Dimensions (HxWxD)	603mm x 424mm x 357mm (23.8x17x14-inches)
Shipping Weight	24 kg (53 lbs)

Dimensions:

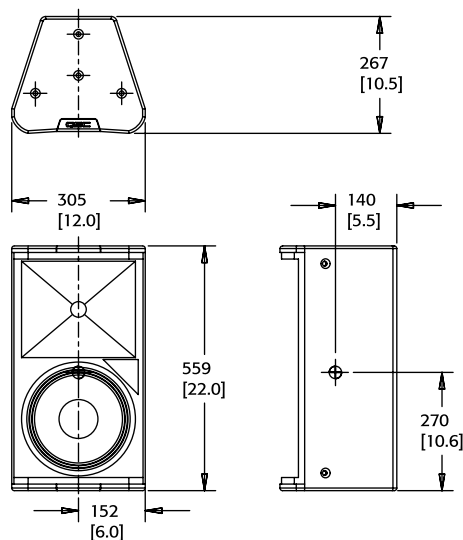

⊕ INDICATES CENTER OF BALANCE

¹ 2 hour rating using IEC60268 noise based on minimum impedance
² Mid-band based on nominal impedance
³ Calculated as the nominal sensitivity plus 10x the log of continuous rated power in volts squared divided by nominal impedance
⁴ Calculated as the continuous calculated max output plus 6dB

As part of QSC's ongoing commitment to product development, specifications are subject to change without notice.



1675 MacArthur Boulevard • Costa Mesa, CA 92626 • Ph: 800/854-4079 or 714/957-7100 • Fax: 714/754-6174

© 2012 QSC Audio Products, LLC. All rights reserved. QSC and the QSC logo are registered trademarks of QSC Audio Products, LLC in the U.S. Patent and Trademark office and other countries. DMT is a trademark of QSC. Speakon is a registered trademark of Neutrik

AP-5102 Spec Sheet 05/23/2013



please recycle